

**INTELLIGENT  
DRIVES &  
CONTROLS  
FOR SHUTTERS  
AND AWNINGS**



# INSTALLATION & OPERATING INSTRUCTIONS

Instructions and notes for installation and operation

## 3T-MOTORS® Shutter / Awning motors with electronical limit switches

**Motor type 3T45-B**  
(For shafts from 60 mm)

**3T45-10B**  
**3T45-20B**  
**3T45-30B**  
**3T45-40B**

**Motor type 3T35-B**  
(For shafts from 40 mm)

**3T35-10B**  
**3T35-13B**

### Attention:

It is important for the safety of persons  
to follow these instructions.  
Keep these instructions for future reference.



## 3T-MOTORS® Shutter motors / Awning motors with electronic limit switches

<b>Guideline / Determine torque</b>	Page 3
<b>! Safety instructions</b>	Page 4
<b>i Function overview</b>	
Scope of delivery	Page 5
Technical data	Page 5
<b>! Installation notes</b>	Page 6
<b>✘ Installation instructions</b>	
Installation shutter motor	Page 7 – 12
• Installation situation	Page 7
• 1) Prepare power connection	Page 7
• 2) Select motor bearing	Page 7 – 8
• 3) Remove shutter shaft	Page 9
• 4) Prepare motor for installation	Page 9
• 5) Mount bearings	Page 9
• 6) Mount motor with shaft unit	Page 9 – 10
• 7) Shutter motor wiring	Page 10
• 8) Setting the end positions	Page 11
• Mounting instructions for motor type 3T35-B	Page 12
Installation awning motor	Page 13 – 15
• 1) Preparation	Page 13
• 2) Prepare motor for installation	Page 13
• 3) Mounting awning motor	Page 13 – 14
• 4) Awning motor wiring	Page 14
• 5) Setting the end positions	Page 15
<b>✘ Troubleshooting</b>	
What to do when ...	Page 16
<b>§ EU Declaration of Conformity</b>	Page 17
<b>⊙ Optional accessories tubular motors</b>	Page 18 – 19



## CONTACT

### 3T-Components GmbH & Co. KG

Grete-Schickedanz-Str. 5  
D-55545 Bad Kreuznach

**Email:** info@3t-components.de

**Tel:** +49 (0)671 887 673-0

**Fax:** +49 (0)671 887 673-99

### Opening hours:

Monday – Friday  
8.00 – 16.30

[www.3t-components.de](http://www.3t-components.de)

Learn more about us:



## © Copyright notice

All contents of these instructions, in particular texts, photographs and graphics, are protected by copyright. Unless expressly indicated otherwise, the copyright is held by 3T-Components GmbH & Co. KG. Please ask us if you wish to use the contents of this document.

# GUIDELINE

With this guide, you can determine the ideal torque in Newton meters (Nm) for the shutter motor.

## DETERMINE WEIGHT ROLLER SHUTTER

### 1.) Determine roller shutter area

$(\text{Height} + 150 \text{ mm}) \times \text{Width} = \text{Roller shutter area (m}^2\text{)}$

### 2.) Determine weight roller shutter material

Take approximate weights per m<sup>2</sup> of roller shutter area from the table.

Material	kg / m <sup>2</sup>
PVC	5
Aluminum Light	6
Aluminum Heavy	9
Steel	11
Wood	11

### 3.) Determine weight roller shutter

$\text{Roller shutter area (m}^2\text{)} \times \text{weight roller shutter material (m}^2\text{)}$

### 4.) Calculate required traction force

Friction losses must be taken into account

(rail guidance) of approx. 10%!

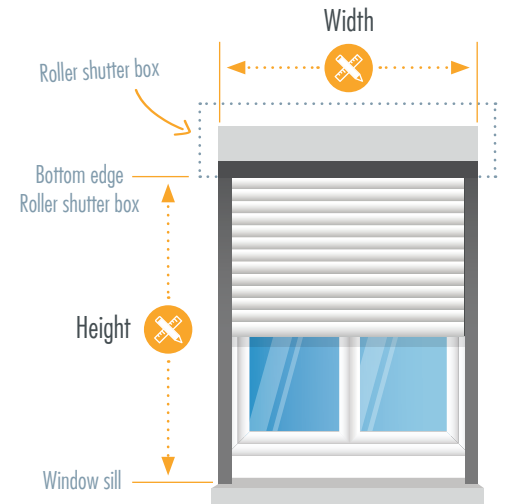

**Roller shutter area (m<sup>2</sup>) x Weight roller shutter material (m<sup>2</sup>) = Weight roller shutter (kg) + 10% Friction losses = Required traction force (kg)**

### Example:

PVC-Roller shutter area 3,00 m<sup>2</sup> x Weight roller shutter material 5 kg = 15 kg Weight roller shutter + 10% Friction losses = 16,5 kg Required traction force

## DETERMINE SHUTTER MOTOR TORQUE

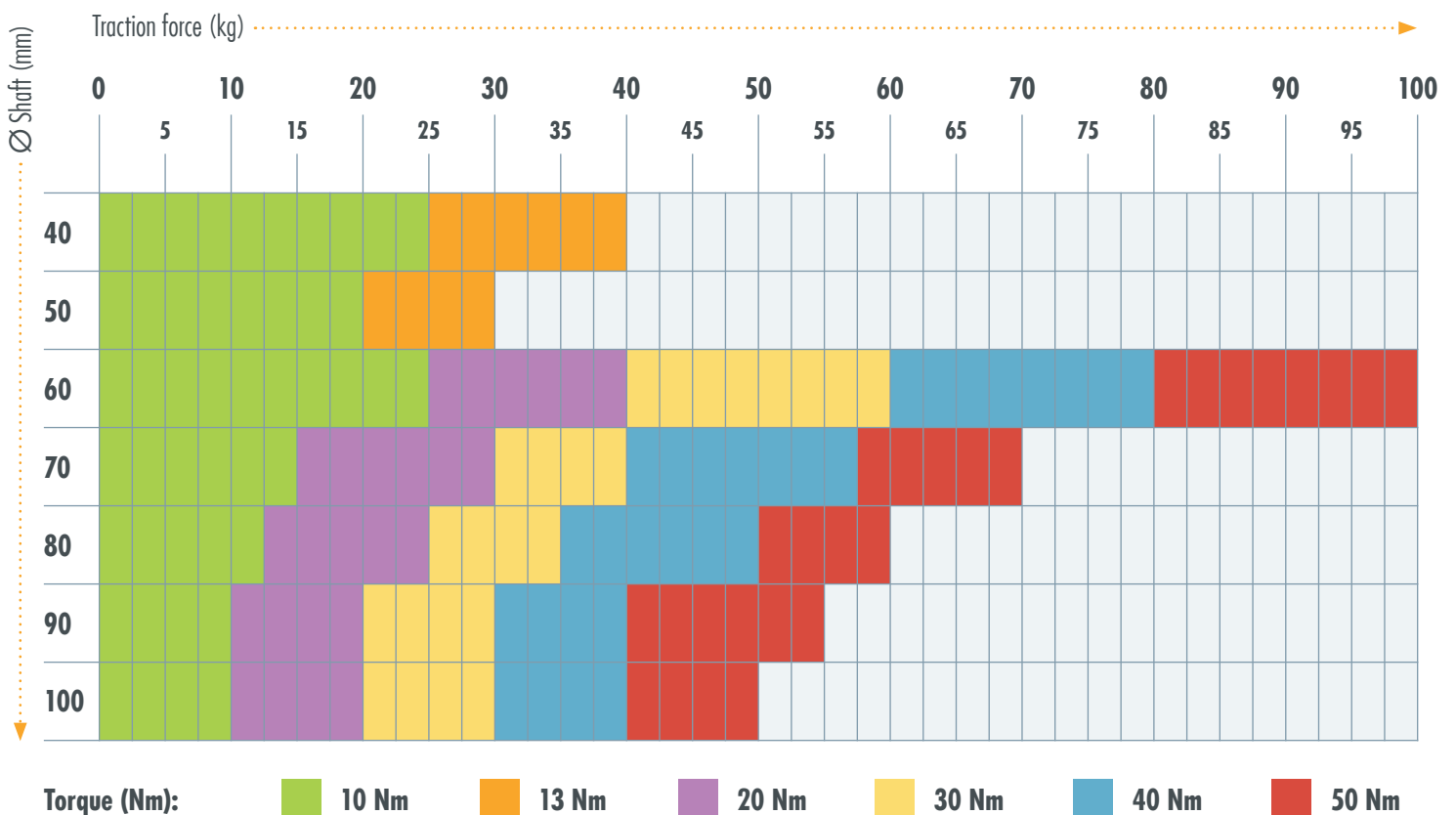

# ! SAFETY INSTRUCTIONS

## Please read these important safety instructions before commissioning!

Incorrect installation can cause serious personal injury and damage to property.

The warranty claim expires in case of non-observance of this user information with all contained notes and regulations.

In case of non-observance of these instructions, the manufacturer or supplier shall not be liable for any personal injury or property damage incurred.



This symbol indicates danger due to electrical energy.  
Danger to persons and objects may arise if the associated information is not observed!

## GENERAL SAFETY INSTRUCTIONS

- **WARNING:** Important safety instructions.  
Follow all instructions as incorrect installation may result in serious injury.
- **WARNING:** The drive must be disconnected from the power source during cleaning, maintenance and replacement of parts.
- Danger to life from electric shock when working on electrical equipment.
- The electrical connection, installation and commissioning of the receiver may only be carried out by qualified personnel.
- Before installing the drive, remove all unnecessary cables and disable all devices, that are not required for operation with power.
- The relevant regulations and guidelines must be followed without fail, to avoid damage to persons and objects.
- Observe safety instructions according to EN 60 335-2-97: The power supply cable of the drives must be laid internally.
- Installation according to DIN 18073: The roller shutter box cover must be easily accessible and removable.
- Installation according to EN 60335: Only switches / pushbuttons / switching devices with a minimum contact opening of 3 mm may be used, furthermore the up and down direction must be interlocked against each other.
- When installing in damp rooms, observe regulations (VDE 0100, part 701 and 702).
- These drives can be connected in parallel without an isolating relay or central control.  
In this case, the max. output power of the command transmitter (timer or otherwise) must be observed.
- Do not use defective devices: Never use defective equipment.  
Periodically inspect the equipment for imbalance and signs of wear or damage to cables and suspension springs.  
Do not use equipment if repair or touch-up is necessary.  
There is a risk of personal injury and property damage due to electric shock or short circuit.
- Retain the instructions for future reference.



This symbol indicates information about general danger.  
Non-observance can mean danger to persons and objects!

## IMPROPER USE

- Persons are to be instructed with the correct operation of the tubular motor.
- The roller shutter movement must be monitored in order not to endanger persons.
- Do not allow children to play with motor controls.
- Store the handheld transmitter in such a way that unintentional operation is prevented (e.g. by children playing).
- The device can be used by children aged 8 years and above and persons with reduced physical, sensory or mental capabilities or lack of experience and knowledge, if they have been given supervision and instruction concerning use of the appliance in a safe way and are aware of the hazards involved.
- Children are not allowed to play with the equipment.
- If the power supply cord of this device is damaged, it must be replaced by the manufacturer or its customer service or a similarly qualified person to prevent hazards.



This symbol indicates important information that can ensure safe and proper use of the device.

## PROPER USE

- Use tubular motors only for automating shutters.
- Only use original components and original accessories from the manufacturer.
- The mains connection cable of the drives must be laid internally in the empty conduit up to the junction box.  
The local electrical regulations must be observed.
- For the electrical connection of the tubular motors, a 230 V / 50 Hz power connection with fuse must be available at the installation site.
- Inspect the installation frequently for imbalance and signs of wear or damage to cables and springs.  
Do not use if repairs or adjustments are required.

# FUNCTION OVERVIEW

## SCOPE OF DELIVERY – MOTOR TYPE 3T45-B

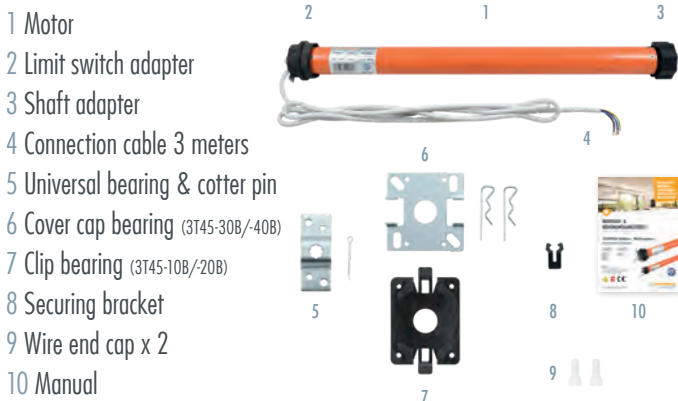

## SCOPE OF DELIVERY – MOTOR TYPE 3T35-B



Optional adapter sets + accessories > Optional accessories tubular motors (Page 18 – 19)

### Technical data

Motor type	3T45-10B	3T45-20B	3T45-30B	3T45-40B	3T35-10B	3T35-13B
Torque (Nm)	10 Nm	20 Nm	30 Nm	40 Nm	10 Nm	13 Nm
Traction power (kg)	25 kg	40 kg	60 kg	80 kg	25 kg	40 kg
Max. PVC shutter area (m <sup>2</sup> )	4,5 m <sup>2</sup>	6 m <sup>2</sup>	9 m <sup>2</sup>	11 m <sup>2</sup>	5,25 m <sup>2</sup>	7 m <sup>2</sup>
Max. ALU shutter area (m <sup>2</sup> )	3 m <sup>2</sup>	4,7 m <sup>2</sup>	7 m <sup>2</sup>	9,5 m <sup>2</sup>	4,2 m <sup>2</sup>	5,5 m <sup>2</sup>
Power (W)	113 W	161 W	200 W	218 W	144 W	144 W
Turn Speed (U/min)	15 U/min	15 U/min	15 U/min	12 U/min	17 U/min	14 U/min
Limit switch capacity (min)	22 U	22 U	22 U	22 U	30 U	30 U
Operating voltage (V AC)	230 V	230 V	230 V	230 V	230 V	230 V
L1 Total motor length (mm)	608 mm	608 mm	656 mm	656 mm	584 mm	584 mm
L2 Installation length (mm)	587 mm	587 mm	635 mm	635 mm	568 mm	568 mm
Connection line (m)	3 m	3 m	3 m	3 m	3 m	3 m
Max. Runtime (min)	4 min	4 min	4 min	4 min	4 min	4 min
Protection class	IP44	IP44	IP44	IP44	IP44	IP44
EAN	4260601761380	4260601761397	4260601761403	4260601761410	4260601761366	4260601761373

# ! INSTALLATION NOTES



**Before installation, all non-essential electrical wiring must be removed, all mechanisms that are not necessary for motorized operation must be deactivated.**

- Do not expose the tubular motor to crushing, impact, falling or contact with any liquids. Do not punch holes in the entire length of the tube (motor casing) or attach screws to it.



- Please use suitable suspension springs to fasten the roller shutter curtain to the roller shutter shaft. You will find suitable suspension springs on page 19 and in our store under mounting accessories.



- Important for motor type 3T35 (SW40):

It is essential to use mini suspension springs for motor operation. These special mini springs protrude only approx. 1 mm into the shaft. This allows the shaft to rotate freely. When using commercially available suspension springs the motor housing is left with grinding marks because the suspension pin protrudes too far into the roller shutter shaft, which leads to damage and destruction of the motor.

Mini suspension springs (Page 19)

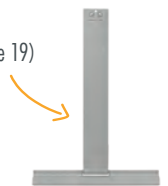

- For steel shafts with a width across flats of 40 mm (SW40), only use shafts with an external fold. Steel shafts with an internal fold will damage and destroy the motor.



Do not use 8-sided shaft SW40 with internal fold!



8-sided shaft SW40 with external fold

- Grinding marks of any kind on the motor housing will void the warranty.



- The inspection cover of the roller shutter box must be easily accessible and removable.

- We recommend using a tubular motor with a power 10% higher than the weight of the shutter, to compensate for the frictional resistance of the rail guide. > See Guideline / Determine torque (page 3)

- The motor is designed for short-time operation (4 min). It has an internal thermal circuit breaker which interrupts the power supply in the event of overheating, e.g. as a result of continuous operation. The cooling phase is min. 10 min, the thermal switch resets automatically. Regular operation is only possible after the the motor has cooled down completely.

# INSTALLATION INSTRUCTIONS



## Please note:

- The motor can be installed on the right-hand side as well as on the left-hand side. If the direction of rotation is reversed, please exchange the wires for the up and down direction.
- The setting of the end positions is only possible in the installed state (motor in shutter shaft).
- Never place screws in the area of the tube motor, as they will damage the motor.
- **Engine damage caused by improper use or unprofessional installation, lead directly to loss of warranty.**

## INSTALLATION SHUTTER MOTOR

### Installation situation

- 1 Counter bearing\*
- 2 Ball bearing\*
- 3 Roller capsule\*
- 4 Shutter shaft\*
- 5 Suspension spring\*
- 6 Shaft adapter
- 7 Tubular motor
- 8 Limit switch adapter
- 10 Limit switches
- 10 Engine mount
- 11 Shutter curtain\*

\* Accessories; not included

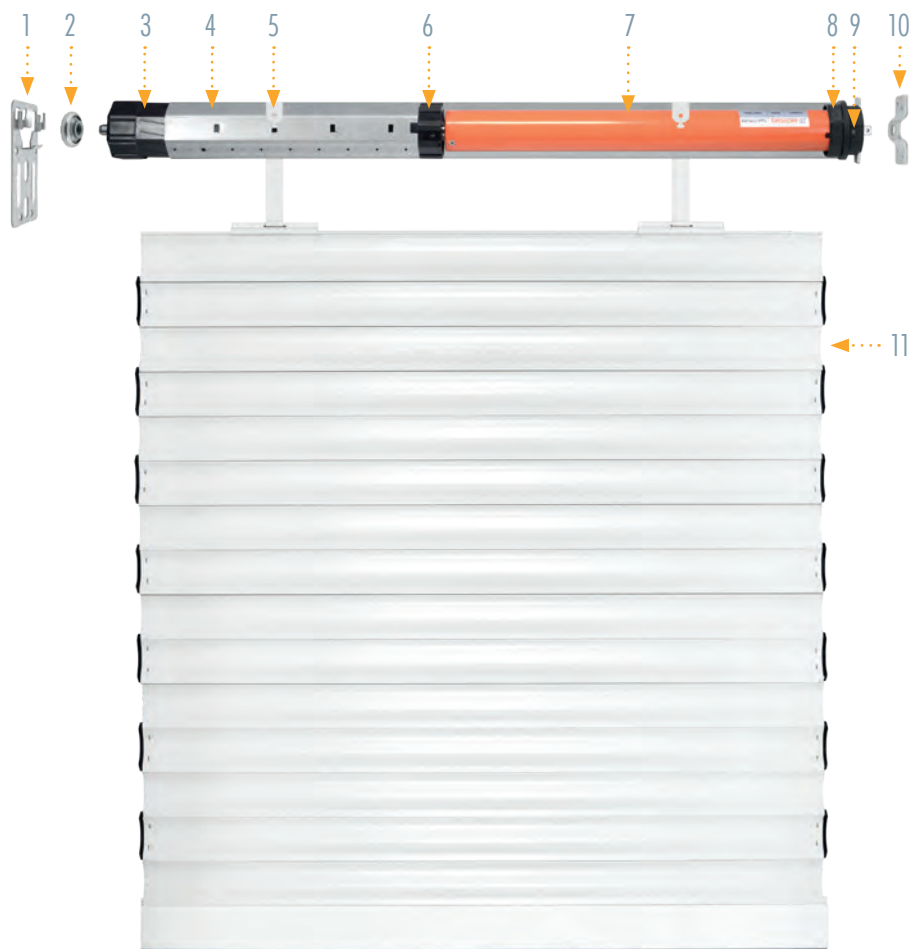

### 1 Prepare power connection:

- The mains connection cable of the drive must be laid internally in the empty conduit up to the junction box. The local electrical regulations must be observed.

### 2 Select motor bearing:

- Two motor bearings are supplied with motor type 3T45-B and 3T35-B: Universal bearing and cover cap bearing (3T45-30B/3T45-40B) / clip bearing.
- Use one of the two motor bearings depending on the installation situation.

# INSTALLATION INSTRUCTIONS

## Motor type 3T45-B

Installation with universal bearing or cover cap bearing / clip bearing



### Installation with universal bearing:

- Push the motor with the square into the opening of the bearing and secure with cotter pin.

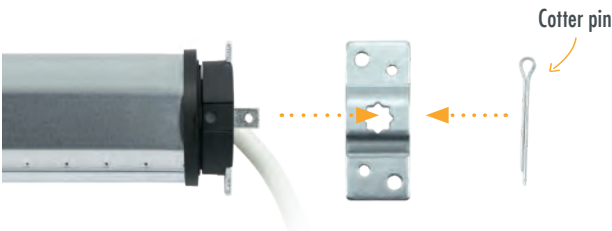

### Installation with cover cap bearing:

- Remove screws from metal plate on motor head > fig. 2.1
- Remove metal plate > fig. 2.2
- Remove motor square spigot > fig. 2.3
- Reattach metal plate > fig. 2.4

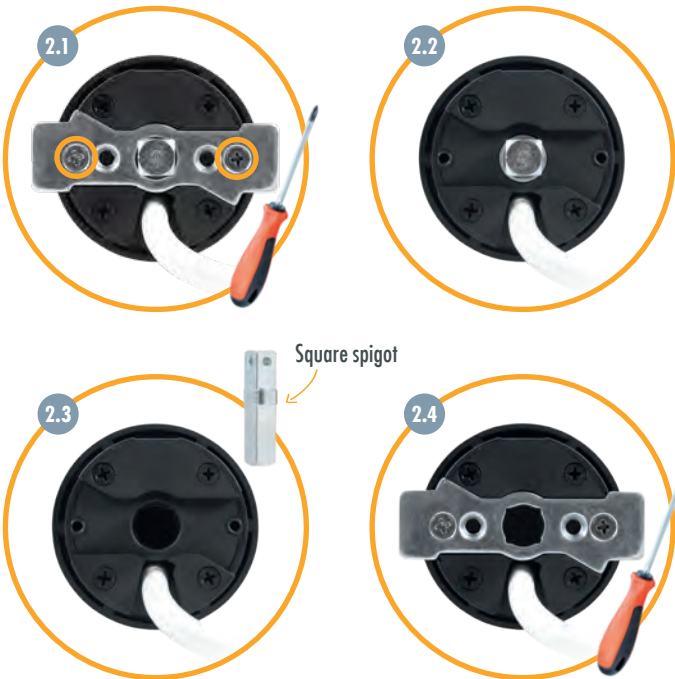

- Slide motor type 3T45-B without square spigot into cover cap bearing and secure with both securing clips / Engage Motor in clip bearing.

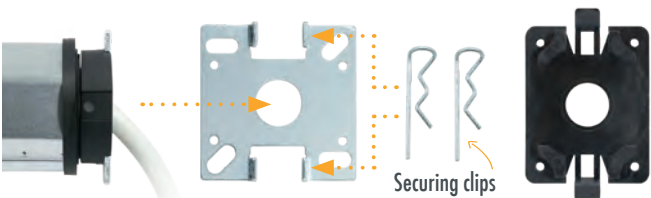

## Motor type 3T35-B

Installation with universal bearing or clip bearing

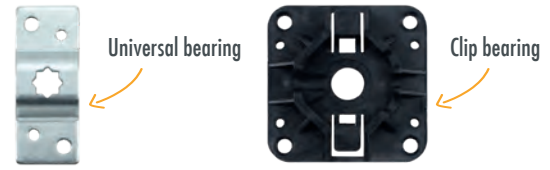

### Installation with universal bearing:

- Push the motor with the square into the opening of the bearing and secure with cotter pin.

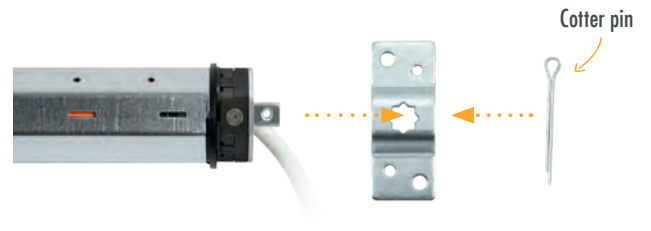

### Installation with clip bearing:

- Remove screws from metal plate on motor head > fig. 2.5
- Remove metal plate > fig. 2.6
- Remove motor square spigot > fig. 2.7
- Reattach metal plate > fig. 2.8



- Engage motor type 3T35-B without square spigot in clip bearing.





# INSTALLATION INSTRUCTIONS

## 3 Remove shutter shaft:

- Lower the roller shutter.
- Open the cover of the roller shutter box.
- Release the suspension springs from the roller shutter shaft.
- Lift roller shutter shaft incl. ball bearing out of the holder.

## 4 Prepare motor for installation:

- Push limit switch adapter flush against motor head. > fig. 4.1 / 4.2
- Secure the shaft adapter with the supplied securing bracket. > fig. 4.3 / 4.4
- Push the motor into the roller shutter shaft without using force (never knock it in). The fold of the shaft must lie over the recess in the shaft adapter. > fig. 4.5 / 4.6
- Make sure that the roller shutter shaft is flush with the motor head limit switch adapter. > fig. 4.7 / 4.8

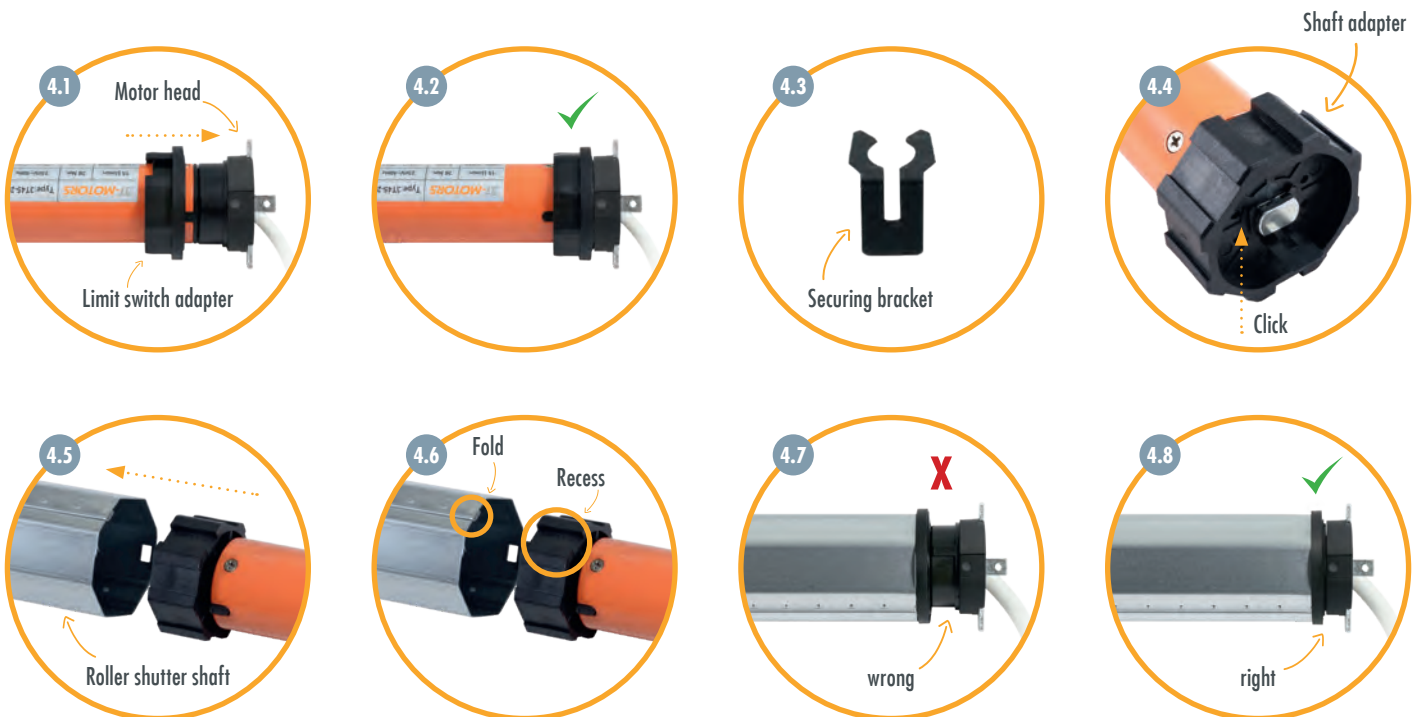

## 5 Mount bearings:

- Remove old wall bearing on motor side (left or right installation possible).
- Mount motor bearing at this point (2 mounting options: Universal bearing and cover cap bearing (3T45-30B/-40B) / clip bearing (3T45-10B/-20B and 3T35-B)).
- Please mount the bearings so that the limit switches are freely accessible.
- Make sure that the roller shutter motor with the shaft unit sits horizontally in the roller shutter box.



## 6 Mount motor with shaft unit:

- Insert the motor head (with the entire shaft unit) into the motor bearing and secure it with the supplied cotter pin or securing clips (Cover cap bearing).

# ✂ INSTALLATION INSTRUCTIONS

- On the opposite side of the motor, push the roller capsule out of the roller shutter shaft until it fits into the ball bearing inserted in the wall bearing.
- Fix roller capsule to roller shutter shaft with self-tapping screw. Position the screw at a punched hole. This prevents the screw from slipping.

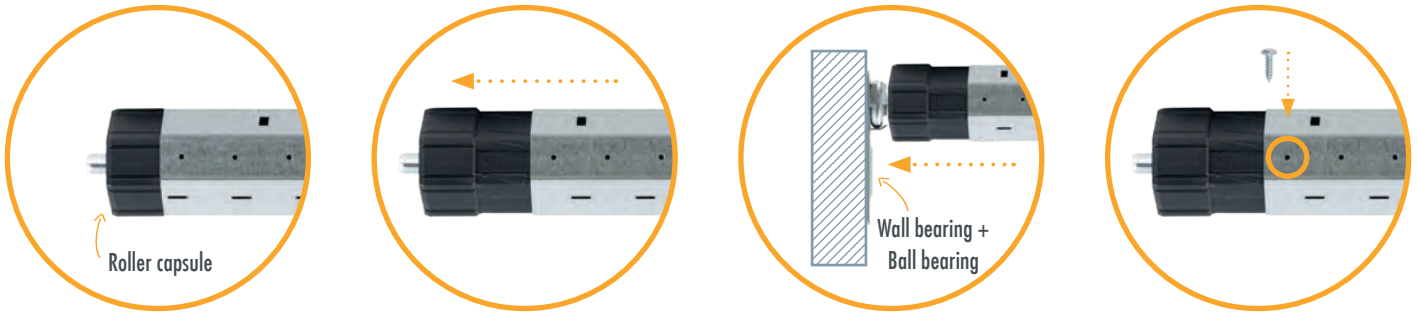

## 7 Shutter motor wiring:

- Connect the roller shutter motor and switch (or timer) to the mains.
- The electrical connection of the roller shutter motor and control unit may only be carried out by qualified personnel.
- If the drive should run in the opposite direction after installation, the motor's upstream and downstream leads (brown + black) must be turned.

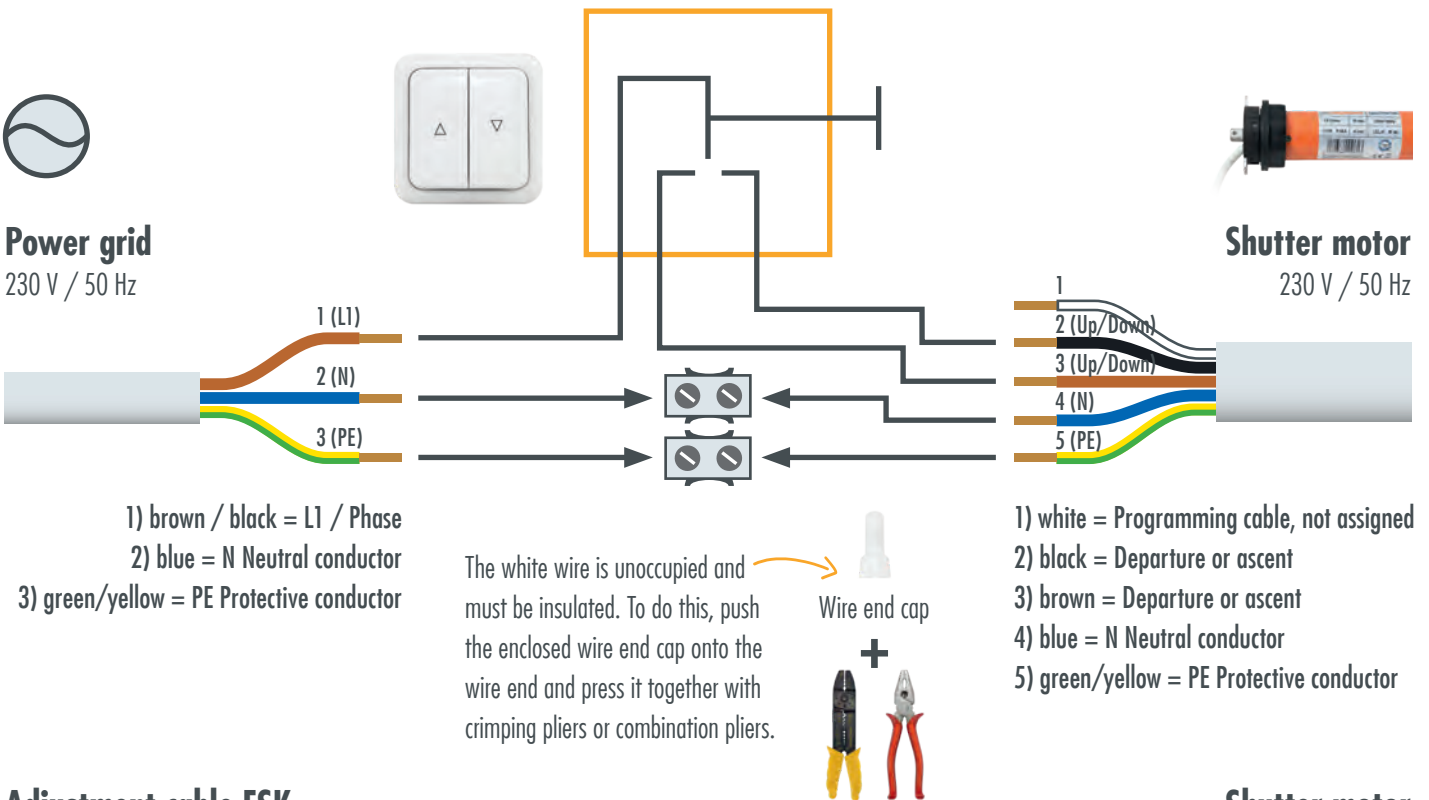

## Adjustment cable ESK

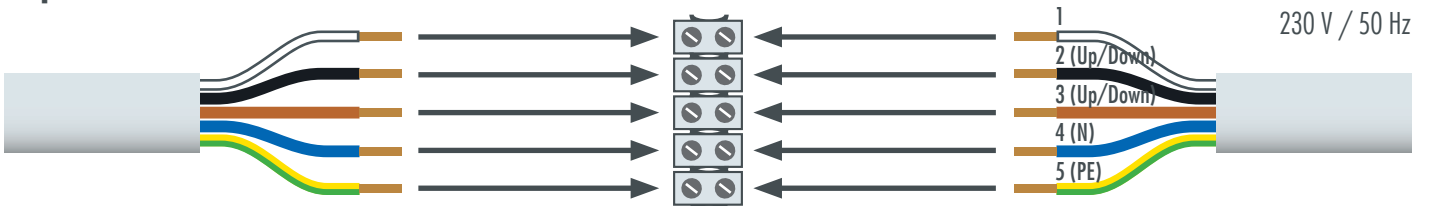

The connection diagram of time switches differs from this circuit diagram! Please refer to the corresponding manual for the connection diagram.



If the end points are set using the ESK setting cable, do not connect the switch or timer until after the end points have been set (page 11)!

# INSTALLATION INSTRUCTIONS

## 8 Setting the end positions:

### Setting the end points with set button

Connect tubular motor to switch or timer



Test the direction of rotation of the motor and change it if necessary.

- To change the direction of rotation, swap the up and down leads (brown and black cable) on the switch/timer.

#### Setting lower end point

- Do not fasten roller shutter arm > fig. 8.1
- Set the switch/timer to „DOWN“ > fig. 8.2
- Run tubular motor in downward direction and define end point by pressing set the set button (motor stops) > fig. 8.3
- If the shaft has to be turned a little to hook in the suspension springs, press the set button. This causes the motor to turn the shaft step by step.

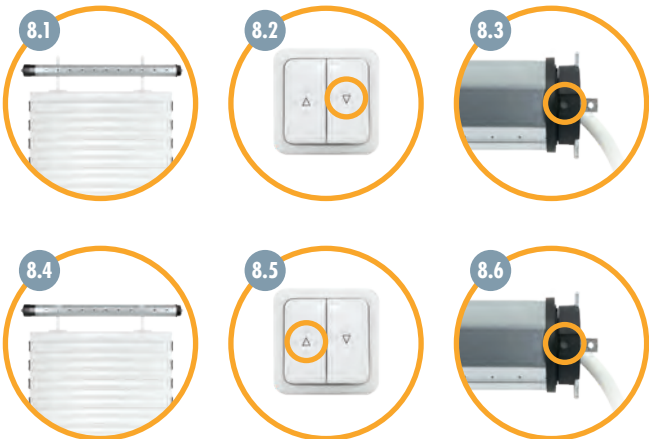

#### Setting upper end point

- Hang the roller shutter curtain with suspension springs on the roller shutter shaft > Abb. 8.4
- Set the switch/timer to „UP“ > Abb. 8.5
- Run the motor with the roller shutter in the upward direction. When the end point is reached, stop the motor by pressing the set button. > Abb. 8.6
- If the motor stops before the upper end point, a readjustment is possible by pressing the set button (switch/timer must be set to „UP“).  
Continuous pressing = motor continues to move upwards.  
Pressing once = motor continues to move upwards step by step.

### Setting the end points with adjustment cable ESK

Connect tubular motor to ESK

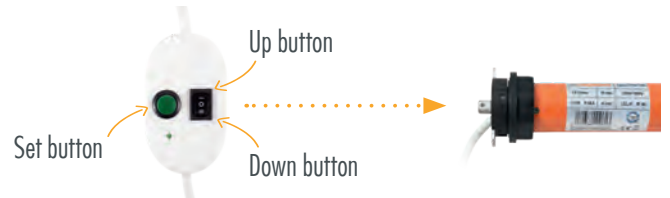

Test the direction of rotation of the motor and change it if necessary.

- To change the direction of rotation, swap the up and down leads (brown and black cable) on the adjustment cable

#### Setting lower end point

- Do not fasten roller shutter arm > fig. 8.7
- Set the switch of the adjustment cable to „DOWN“ > fig. 8.8
- Run tubular motor in downward direction and define end point by pressing the green set button (motor stops) > fig. 8.9
- If the shaft has to be turned a little to hook in the suspension springs, press the set button. This causes the motor to turn the shaft step by step.

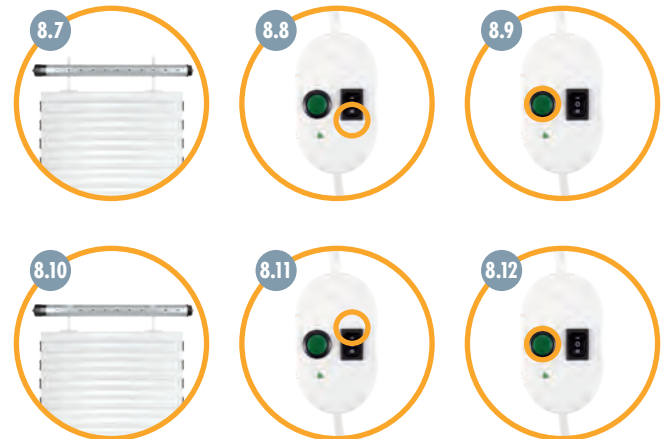

#### Setting upper end point

- Hang the roller shutter curtain with suspension springs on the roller shutter shaft > Abb. 8.10
- Set the adjustment cable to „UP“ > Abb. 8.11
- Run the motor with the roller shutter in the upward direction. When the end point is reached, stop the motor by pressing the green set button. > Abb. 8.12
- If the motor stops before the upper end point, a readjustment is possible by pressing the set button (ESK must be set to „UP“).  
Continuous pressing = motor continues to move upwards.  
Pressing once = motor continues to move upwards step by step.

# INSTALLATION INSTRUCTIONS

## MOUNTING INSTRUCTIONS FOR 3T-MOTORS® MINI-TUBE MOTORS MOTOR TYPE 3T35-B



### Use proper suspension springs:

- To fasten the roller shutter curtain to the roller shutter shaft, please be sure to use suitable suspension springs for motor operation. These special mini suspension springs only protrude approx. 1 mm into the shaft. This allows the shaft to rotate freely. When commercially springs are used, there will be grinding marks on the motor housing because the suspension pin protrudes too far into the roller shutter shaft, which leads to damage and destruction of the motor. In case of any kind of grinding marks on the motor housing, the warranty claim is void.



- Mini suspension springs > Optional tubular motor accessories (page 18 – 19)



Suspension spring

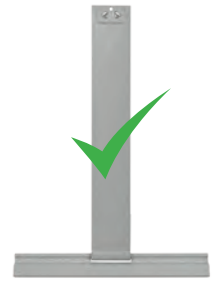

Mini Suspension spring

### Use correct roller shutter shaft with external fold:

- For steel shafts with a width across flats of 40 mm (SW40), only use shafts with an external fold. Steel shafts with an internal fold will damage and destroy the motor.



Do not use  
8-sided shaft SW40  
with internal fold!



8-sided shaft SW40  
with external fold



### Explanation:

- Avoid overstressing and resulting premature aging of the motor by using the correct suspension springs and the correct roller shutter shaft with external fold!
- Keep in mind that the motor housing has a diameter of 35 mm and the roller shutter shaft SW40 has an outer diameter of 40 mm. When using commercially available springs or roller shutter shafts with internal fold, the motor housing will be left with grinding marks, since the suspension pin or the fold protrude too far into the roller shutter shaft. Contrary to its intended use, the motor runs permanently against an overload and outside its characteristic data.
- Matching roller shutter shafts SW40 > Optional tubular motor accessories (page 18 – 19)

# INSTALLATION INSTRUCTIONS

## INSTALLATION AWNING MOTOR

### 1 Preparation:

- Screw in awning & secure with straps or ropes.
- Remove awning from wall bracket & place on safe surface.



#### Attention:

Awning arms are under strong tension!

### 2 Prepare motor for installation:

- Slide limit switch adapter flush against motor head. > fig. 2.1 / 2.2
- Secure the shaft adapter with the supplied securing bracket. > fig. 2.3 / 2.4

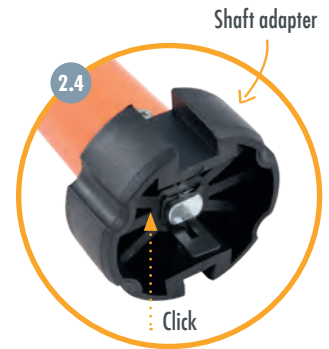
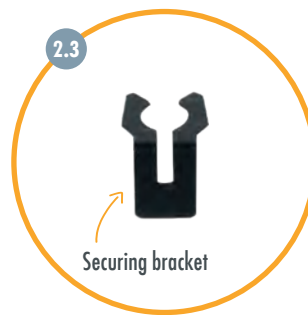

### 3 Installation awning motor:

- Remove the cover to access the side bearing (also awning bracket) and fastening screws. > fig. 3.1
- Loosen the screw that secures the side bearing to the support tube. > fig. 3.2
- Remove all screws connecting the side bearing and the crank mechanism. > fig. 3.3
- Remove the side bearing from the support tube. > fig. 3.4
- Remove the crank mechanism. > fig. 3.5

- Remove the shaft capsule from the shaft. > fig. 3.6  
If the shaft capsule is tight, use a hammer and screwdriver. Be careful not to damage the shaft.
- Push the awning motor with shaft adapter first into the shaft. > fig. 3.7
- Make sure motor head & limit switch adapter are flush in shaft.
- Screw the universal bearing onto the side bearing on the side facing the awning shaft. > fig. 3.8

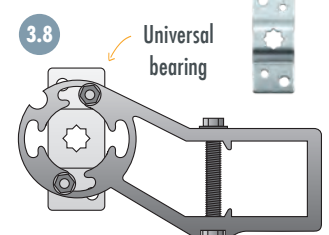
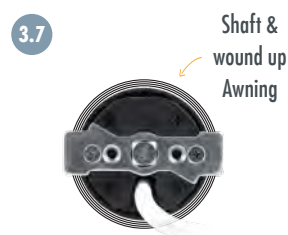
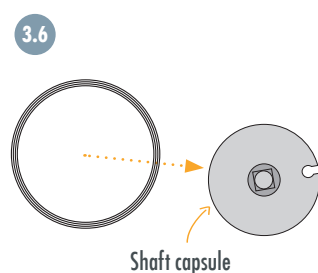
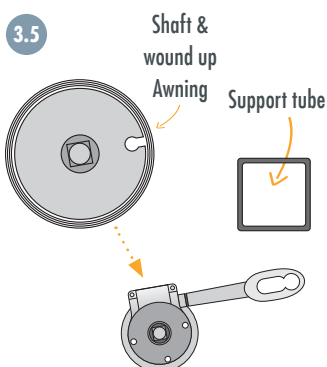
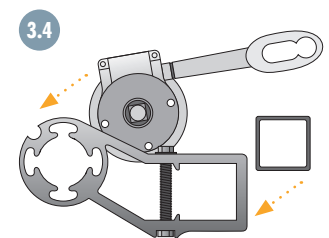
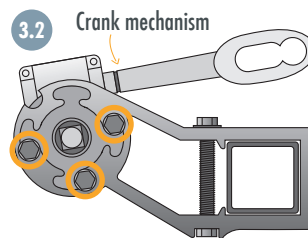
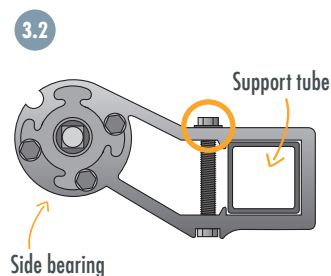
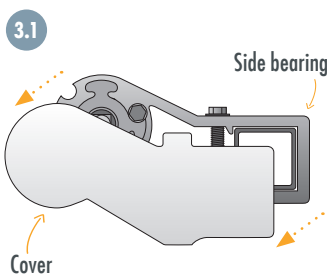

# ✂ INSTALLATION INSTRUCTIONS

- Slide the side bearing with universal bearing onto the support tube & fasten. > fig. 3.9
- Ensure that the motor square spigot is properly engaged in the universal bearing. > fig. 3.10
- Secure the motor square spigot with the supplied cotter pin. > fig. 3.11
- Attach the cover to the side bearing. > fig. 3.12
- Install awning & release fuses.

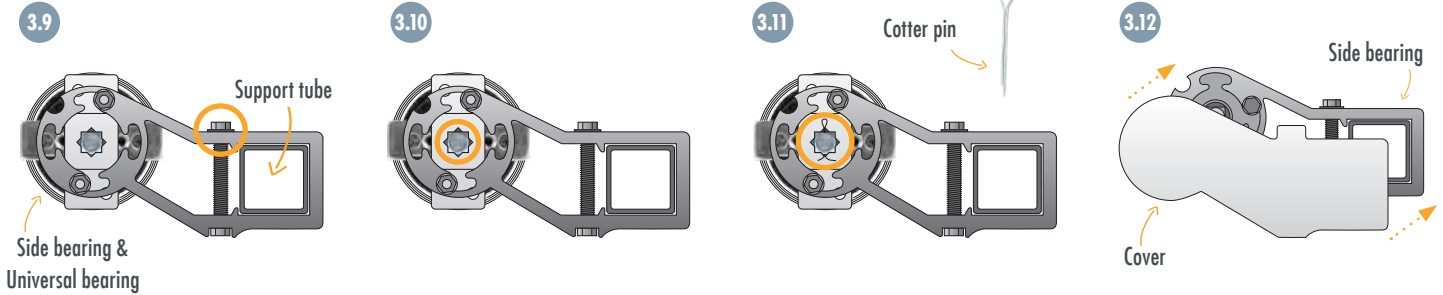

## 4 Awning motor wiring:

- Connect the awning motor and switch (or timer) to the mains.
- The electrical connection of the awning motor and control may only be carried out by qualified personnel.
- If the drive should run in the opposite direction after installation, the motor's upstream and downstream leads (brown + black) must be turned.

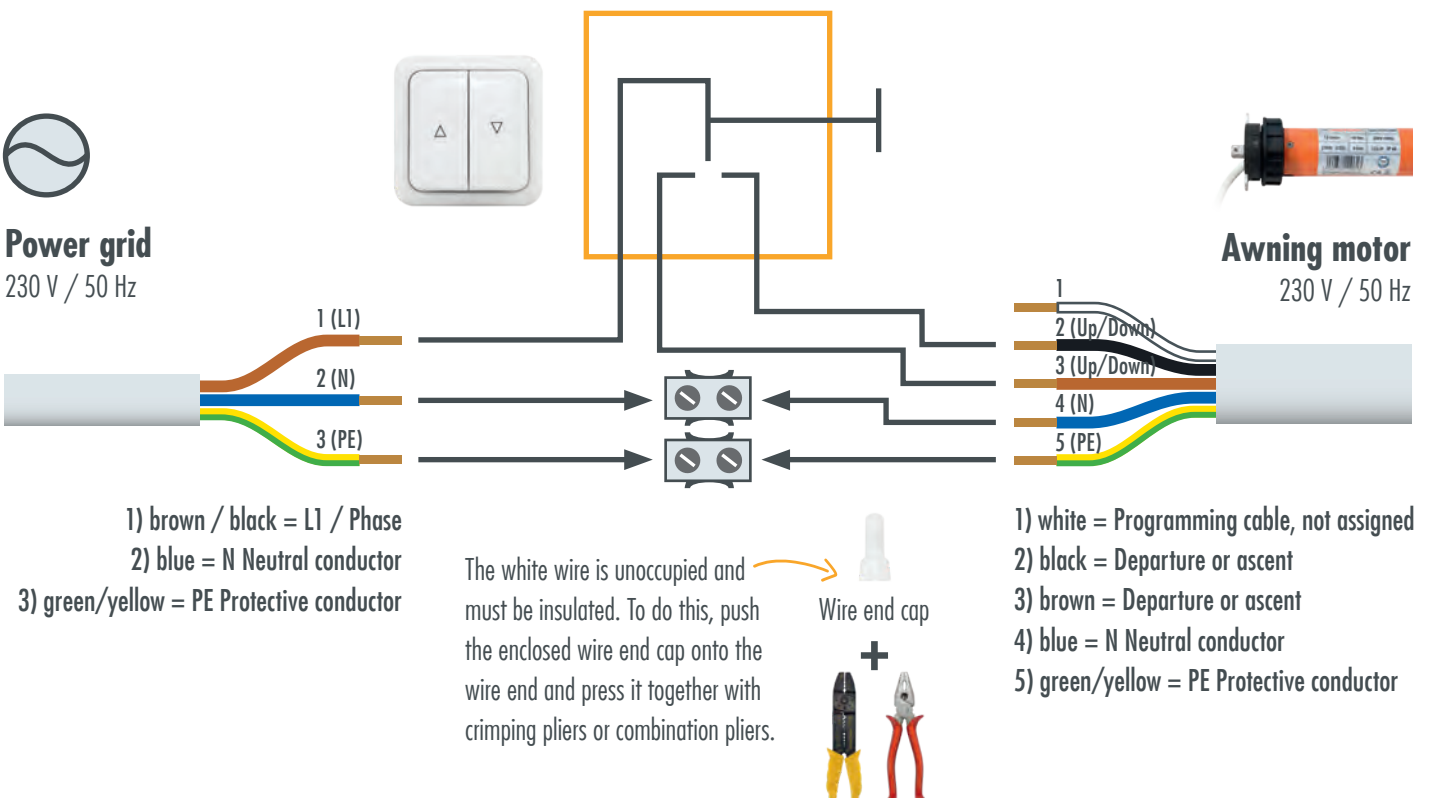

## Adjustment cable ESK

The connection diagram for the ESK can be found on page 10.



The connection diagram of time switches differs from this circuit diagram! Please refer to the corresponding manual for the connection diagram.



If the end points are set using the ESK, do not connect the switch or timer until after the end points have been set (page 11)!

# ✂ INSTALLATION INSTRUCTIONS

## 5 Setting the end positions:

### Setting the end points with set button

Connect tubular motor to switch



#### Test direction of rotation

- Press Up button (Arrow up) = Awning moves IN
- Press Down button (Arrow down) = Awning moves OUT

#### Change the direction of rotation of the motor if necessary

- To change the direction of rotation, swap the up and down leads (brown and black cable) at the switch

#### Setting the position „EXTEND“

- Set the switch to „DOWN“ > fig. 8.1
- Awning moves OUT > fig. 8.2
- Run the tubular motor in the „EXTEND“ direction and set the end point by pressing the set button (motor stops). > fig. 8.3
- If the motor stops before the „EXTEND“ end point, a readjustment is possible by pressing the set button (switch must be set to „DOWN“). Continuous pressing = motor continues to extend continuously. Pressing once = motor continues to extend step by step.

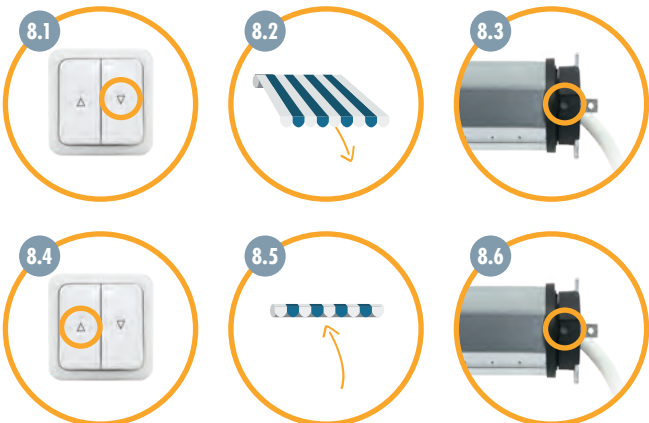

#### Setting the position „RETURN“

- Set the switch to „UP“ > fig. 8.4
- Awning moves IN > fig. 8.5
- Run the tubular motor in the „RETURN“ direction and set the end point by pressing the set button (motor stops). > fig. 8.6
- If the motor stops before the „RETURN“ end point, a readjustment is possible by pressing the set button (switch must be set to „UP“). Continuous pressing = motor continues to return continuously. Pressing once = motor continues to return step by step.

### Setting the end points with adjustment cable ESK

Connect tubular motor to ESK

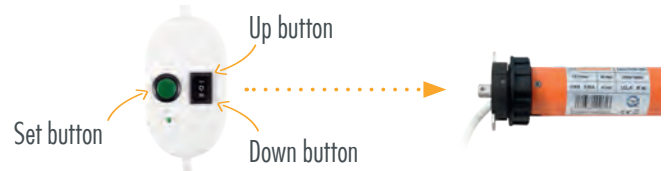

#### Test direction of rotation

- Press Up button = Awning moves IN
- Press Down button = Awning moves OUT

#### Change the direction of rotation of the motor if necessary

- To change the direction of rotation, swap the up and down leads (brown and black cable) at the setting cable

#### Setting the position „EXTEND“

- Set the adjustment cable to „DOWN“ > fig. 8.7
- Awning moves OUT > fig. 8.8
- Run the tubular motor in the „EXTEND“ direction and set the end point by pressing the green set button (motor stops). > fig. 8.9
- If the motor stops before the „EXTEND“ end point, a readjustment is possible by pressing the green set button (ESK must be set to „DOWN“). Continuous pressing = motor continues to extend continuously. Pressing once = motor continues to extend step by step.

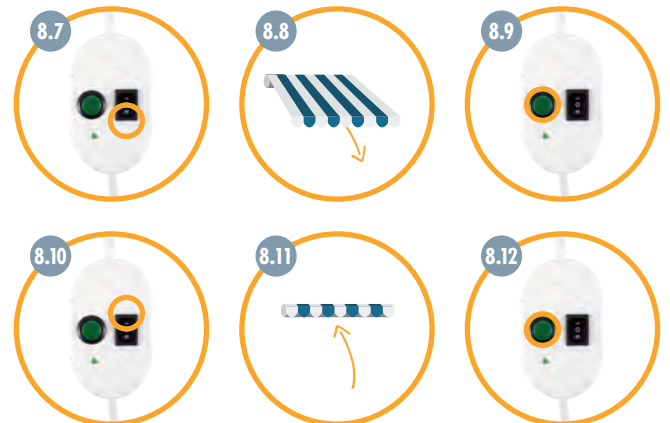

#### Setting the position „RETURN“

- Set the setting cable to „UP“ > fig. 8.10
- Awning moves IN > fig. 8.11
- Run the tubular motor in the „RETURN“ direction and set the end point by pressing the green set button (motor stops). > fig. 8.12
- If the motor stops before the „RETURN“ end point, a readjustment is possible by pressing the green set button (ESK must be set to „UP“). Continuous pressing = motor continues to return continuously. Pressing once = motor continues to return step by step.

# TROUBLESHOOTING

---

## WHAT TO DO WHEN ...

### ... the motor does not run?

- Mains voltage is missing.
  - Check correct connection of the control (switch or timer).
- 

### ... the motor is running in the wrong direction?

- Swap the two wires for the direction of rotation (brown + black).
- 

### ... the motor does not switch off at the set point?

- Check fit of limit switch adapter (must be flush with motor head and shutter shaft).
  - Roller capsule is not fixed or roller shutter shaft is too short.
- 

### ... the motor does not switch off at all?

- Limit switches are too far apart: See setting the end points with set button or ESK setting cable (roller shutter motor: page 11 / awning motor: page 15).
- 

### ... the motor stops running after continuous operation?

- The thermal protection switch of the motor has tripped. After a cooling phase (min. 10 min.), the motor is ready for operation again.
- 

### ... the motor turns in only one direction?

- Check correct connection of the control (switch or timer).
  - Check limit switch: See setting the end points with set button or ESK setting cable (roller shutter motor: page 11 / awning motor: page 15).
- 

### ... the motor does not operate at the specified speed?

- Check roller shutter weight; if necessary, correct inclined installation of roller shutter shaft or Eliminate mechanical friction in the roller shutter box or rail guide.



## EU Konformitätserklärung

**Wir, die Firma**

3T Components GmbH & Co. KG  
Grete-Schickedanz-Str. 5  
55545 Bad Kreuznach  
Deutschland

**erklären in alleiniger Verantwortung, dass das weiter unten genannte Produkt**

Geräteart: Rohrmotor mit elektronischen Endschaltern

Modell Artikelnummer

3T35-10B	365
3T35-13B	366
3T45-10B	367
3T45-20B	368
3T45-30B	369
3T45-40B	370

**die grundlegenden Anforderungen der aufgeführten EG/EU-Richtlinien erfüllt:**

2014/35/EU	Niederspannungsrichtlinie
2014/30/EU	EMV-Richtlinie
2011/65/EU	RoHS-Richtlinie
2012/19/EU	WEEE-Richtlinie

**angewandte Standards und Verordnungen:**

EN 60335-1:2012/A13:2017  
EN 60335-2-97:2006/A12:2015  
EN 55014-1:2017  
EN 55014-2:2015  
EN 61000-3-2:2014  
EN 61000-3-3:2013

**Bevollmächtigter zur Zusammenstellung der technischen Unterlagen:**

Name, Position: Patrick El Hadj-Henni, Geschäftsführer

Wallertheim, 08.10.2019  
.....  
Datum

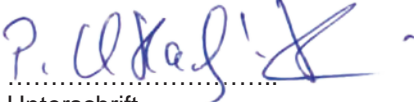
  
.....  
Unterschrift

# OPTIONAL ACCESSORIES TUBULAR MOTORS

## ADAPTER SETS 3T35 | ADAPTER SETS 3T45 | MOTOR BEARINGS

### Adapter set 40 mm round

- Adapter set for 40 mm round shaft
- Suitable for motor type 3T35/3T35-R

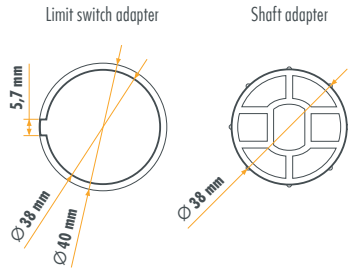

### Adapter set 50 mm 8-sided

- Adapter set for octagonal shafts SW50
- Suitable for motor type 3T35/3T35-R

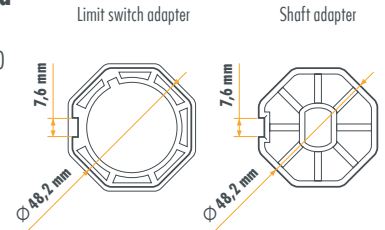
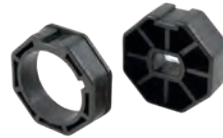

### Adapter set 60 mm 8-sided

- Adapter set for octagonal shafts SW60
- Suitable for motor type 3T45/3T45-R

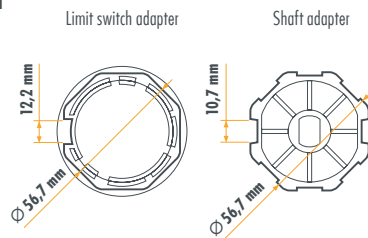

### Adapter set 70 mm 8-sided

- Adapter set for octagonal shafts SW70
- Suitable for motor type 3T45/3T45-R

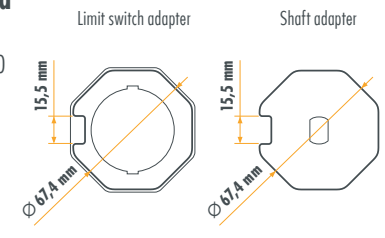

### Adapter set 63 mm round

- Adapter set for 63 mm round shaft
- Suitable for motor type 3T45/3T45-R

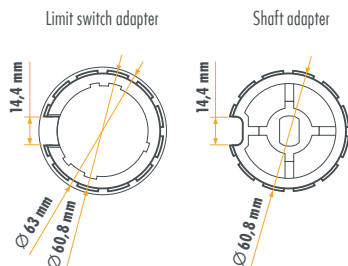

### Adapter set 70 mm round

- Adapter set for 70 mm round shaft
- Suitable for motor type 3T45/3T45-R

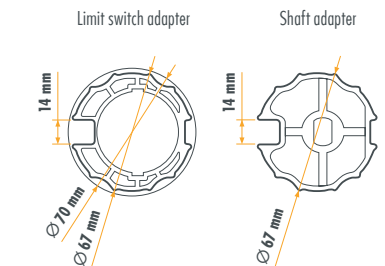

### Adapter set 78 mm round

- Adapter set for 78 mm round shaft
- Suitable for motor type 3T45/3T45-R

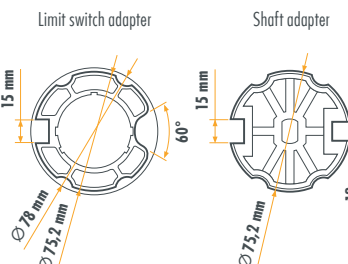

### Adapter set 85 mm round

- Adapter set for 85 mm round shaft
- Suitable for motor type 3T45/3T45-R

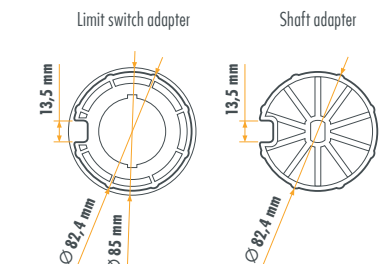

### Engine bearing / Roll-off bearing

- Enables the rolling shutter to unroll in case of defective motor or power failure
- Motor bearing for tubular motors with Square spigot 10 x 10 mm
- Suitable for all 3T-MOTORS Tubular motors

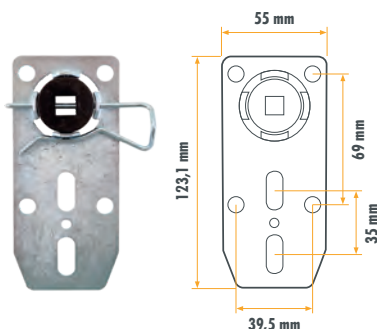

### Refurbishment bearing / Push-on bearing

- Adjustable clamp bearing for mounting onto existing brackets
- Motor bearing for tubular motors with Square spigot 10 x 10 mm
- Suitable for all 3T-MOTORS Tubular motors

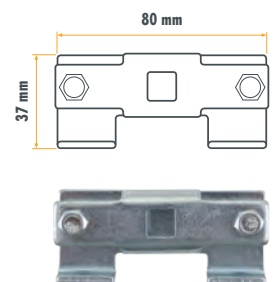

# OPTIONAL ACCESSORIES TUBULAR MOTORS

ANTI-LIFT DEVICE | SHUTTER SHAFTS | ROLLER CAPSULE | SUSPENSION SPRINGS | BALL BEARINGS

## OCTOCLICK Anti-lift device 2-link / 2,5-link

- Burglar-resistant
- The pushing up of a closed motorized roller shutter is prevented
- For tubular motors with electronic or mechanical limit switching
- For 50 mm (SW50) and 60 mm (SW60) octagonal shafts
- For roller shutter armor with thickness 8 mm + 14 mm (mounting profile can be rotated)
- Made of glass fiber reinforced polyamide
- No tooling required



## Shutter shafts SW60 / SW40

8kant steel shafts / shaft sets

- SW60 (diameter: 60 mm) up to roller shutter box width: 110 cm / 150 cm / 190 cm / 270 cm / 310 cm / 350 cm
- SW40 (diameter: 40 mm) up to roller shutter box width: 110 cm / 140 cm / 160 cm



## Roller capsule long SW60

High quality product

- Length: 140 mm
- Length Steel pin: 12 mm
- PVC



## Roller capsule long SW40

High quality product

- Length: 80 mm
- Length Steel pin: 9,8 mm
- PVC



## Suspension spring Maxi

Required when using roller shutter motors

- Maxi spring up to 65 mm profile height
- For roller shutter shaft SW60
- Powder coated
- Anti-burglary effect
- Pick up width: 100 mm
- Total length: 215 mm



## Suspension spring Mini

Required when using roller shutter motors

- For roller shutter shaft SW40
- Powder coated
- Anti-burglary effect
- Pick up width: 100 mm
- Total length: 140 mm



## Ball bearing Maxi

Maxi ball bearing for use in roller shutter bearing

- Outer diameter: 40 mm
- Inner diameter: 12 mm
- Specialized trade quality



## Ball bearing Mini

Mini ball bearing for use in roller shutter bearing

- Outer diameter: 28 mm
- Inner diameter: 10 mm
- Specialized trade quality



# INTELLIGENT DRIVES & CONTROLS FOR SHUTTERS AND AWNINGS

*Service and  
Quality  
make the  
difference!*



## Social Media Links

Info, news and tips on roller shutters, awnings, smart home and more:

[www.facebook.com/3TComponents](https://www.facebook.com/3TComponents)



[bit.ly/youtube-3TComponents](https://bit.ly/youtube-3TComponents)



[www.instagram.com/3tcomponents](https://www.instagram.com/3tcomponents)



[twitter.com/3TComponents](https://twitter.com/3TComponents)



### 3T-Components GmbH & Co. KG

Grete-Schickedanz-Straße 5  
D-55545 Bad Kreuznach

**Email:** [info@3t-components.de](mailto:info@3t-components.de)

**Tel:** +49 (0)671 887 673-0

**Fax:** +49 (0)671 887 673-99

[www.3t-components.de](http://www.3t-components.de)

### Opening hours:

Monday – Friday / 8.00 – 16.30

**3T-COMPONENTS**  
GmbH & Co. KG